

Mounting Instructions

Series 883 Hose Reel - Air/Water/Oil/Grease/Fluids

Walls, ceiling, bench or floor mount on a level surface according to the diagrams. Utilize bolt hole template on side of carton. Secure suitable bolts to stand a torque of 855 lb. (3800N). Avoid direct influence of strong chemicals or IR heat radiation.

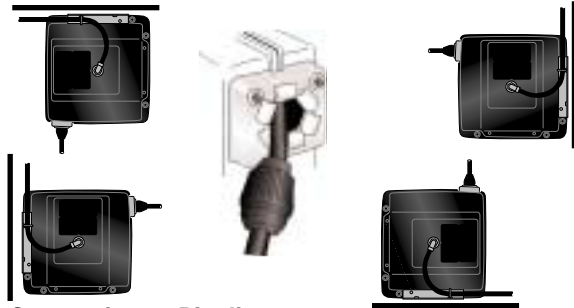

Connection to Pipeline

The reel must be connected to the pipe work with the 3' supply hose passing through the retaining ring fastened to the side of the bracket. Install the shut-off-valve in the pipeline above the hose connection.

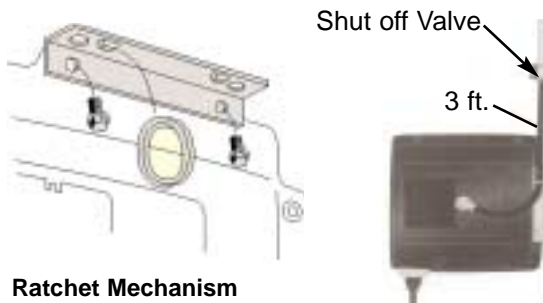

Ratchet Mechanism

A ratchet mechanism retains the hose at the desired outdrawn position. The ratchet will disengage when the hose is drawn out a little further, and then the hose recoils on the drum. The hose should be held by hand as long as possible during the recoiling function. Removing the ratchet will disengage the ratchet. In that case the hose must first be completely recoiled.



Mounting Hose

1. Place reel on a bench, match hose diameter and pressure to the label.
2. **Important:** Ensure that there is no tension on the spring.
3. Remove the plastic cover. Feed the hose through the reel out let and attach it to the nipple on the drum shaft. Replace the plastic cover.
4. Mount the hose stop near the end of the hose.
5. Reel the hose on to the reel by turning the spring loaded hub with a screwdriver. Once the hose has been wound on to the drum, ensure that the right tension has been obtained by turning the hub a further 3 revolutions for 3/8" hose or 6 revolutions for 1/2" hose.
6. Connect the 3' inlet hose, pass through ring.

7. Mount the reel.
8. Check that the required length of hose can be unwound with out stretching the spring to its limit.
9. Turn on the supply and check that the hose connections don't leak.
10. Mount end accessories after lines are flushed.



Adjustment of Spring Tension

- 2a. Increase Spring Tension
- 2b. Decrease Spring Tension

Note: If the spring power has been increased, check that the required length of hose can be drawn out without stretching the spring to the limit.

Annual Maintenance

1. Check the spring function by testing if the hose recoils properly.
2. Check the swivel and hose couplings for leaks, change seal if required. Clean the swivel and couplings.
3. Check that the hose is intact, clean hose.
4. Check the ratchet mechanism on the reel.
5. Check the mounting bolts for security.

Repairs

- Warning:** Before starting any operation:
- a. turn off the supply of air / water / oil / grease / fluid
 - b. neutralize the spring power by removing the hose stop and let the hose recoil.

