

MAGNA STACK[®]

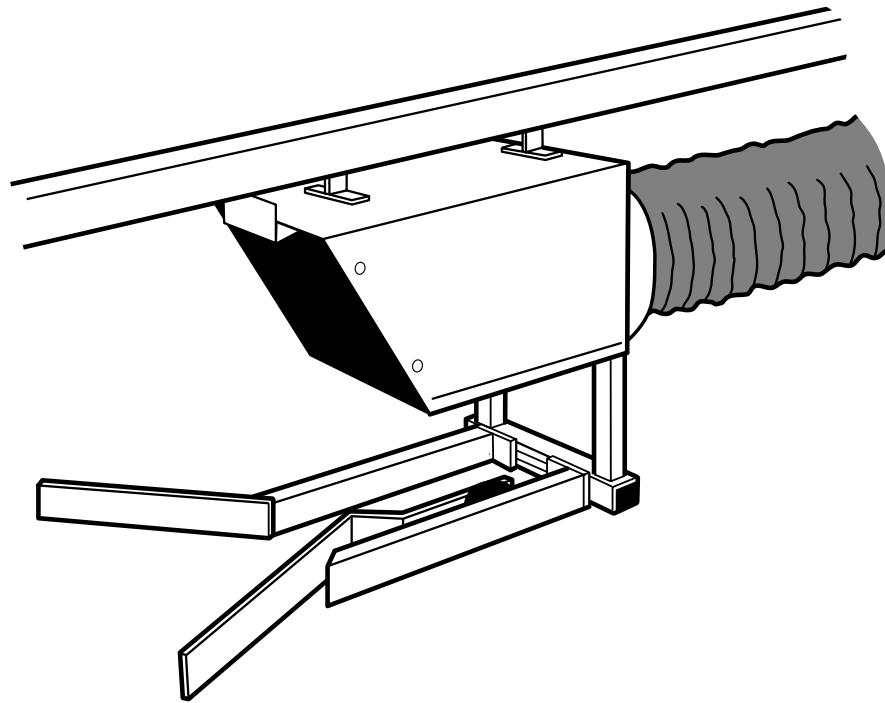

User Instructions

Description

Magna Stack is an exhaust extraction system designed for vehicles with stacks, i.e. vertical exhaust pipes. Since the extraction unit operates at a constant height from the floor the system is normally used in garages etc. where each vehicle has its own parking place.

The flexible hose can withstand **150°C for continuous running and 180°C for short periods**. Use at higher temperatures will shorten the life of the product. **Therefore, avoid tasks that require extended periods of continuous running which will generate high exhaust temperatures.**

Assembly Instructions

1. Decide a suitable height of the exhaust track by measuring the height H of the vehicle to the leading edge of the exhaust pipe, and to this measurement add 285 mm. Check that the floor doesn't slope or that there are no irregularities in the floor. If there should be any irregularities, the measurement should be from the highest point of the floor of the individual parking space. The maximum height of the vehicle should be measured with full air pressure in the tyres and with empty water tanks.

To achieve the correct mounting height the track should hang from support beams. Another possibility is to adjust the height of the exhaust pipe.

The distance from the tracks leading edge to the garage door, should be large enough so the door can open freely without interference with the track.

When assembling the exhaust track, ensure that suitable fixing bolts are used considering total weight and ceiling construction material.

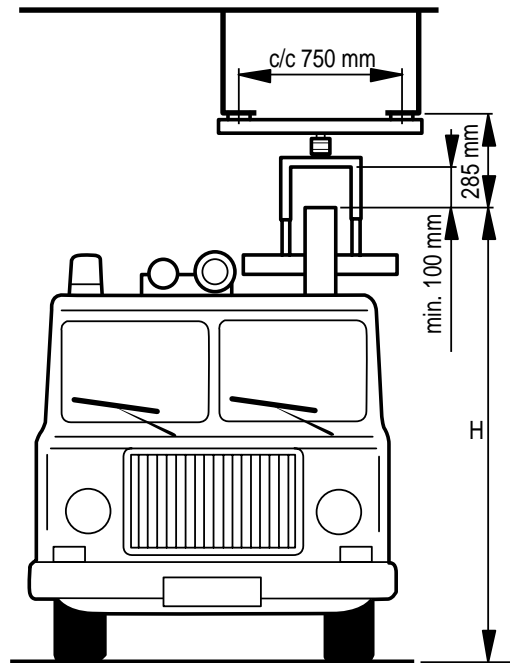

Track length	3 m	6 m	9 m	12 m	15 m
Total weight	35 kg	45 kg	55 kg	65 kg	75 kg

2. Install the suspension guide tracks in parallel at a distance of 3 metres apart. **N.B.** The external guide tracks must be fitted with a spring.

3. Hang the track in the mounting brackets. The distance from the brackets to the tracks end, must be 1.5 m. Adjust the tracks and check that there are no sharp edges or irregularities at the track joints.

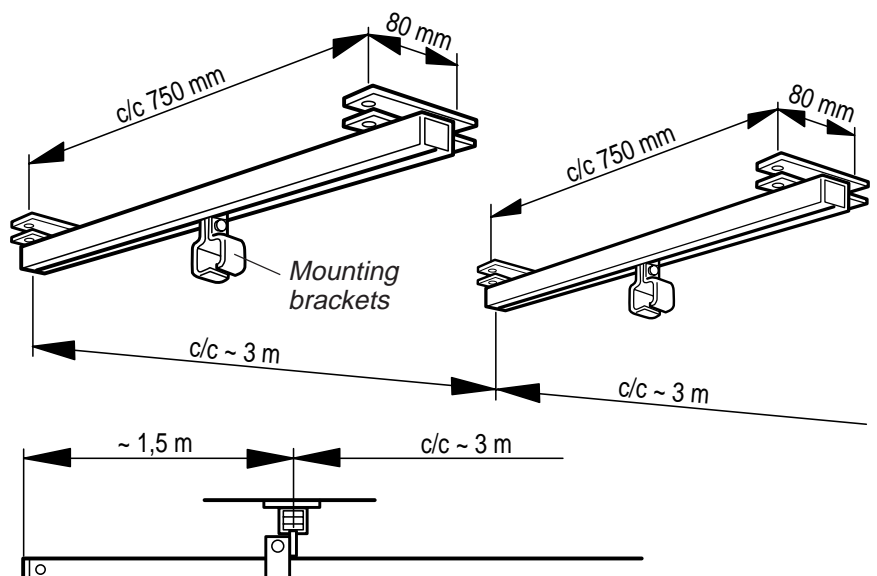

ENGLISH

4. Fit the safety stop with the bolt supplied in the leading edge of the track.

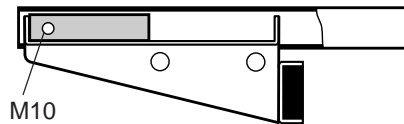

5. Screw the hose connector on the extraction unit (NB! Positioned with the arrows in line, see figure). Drill four holes 3,5 mm dia. and use the screws supplied with the unit.

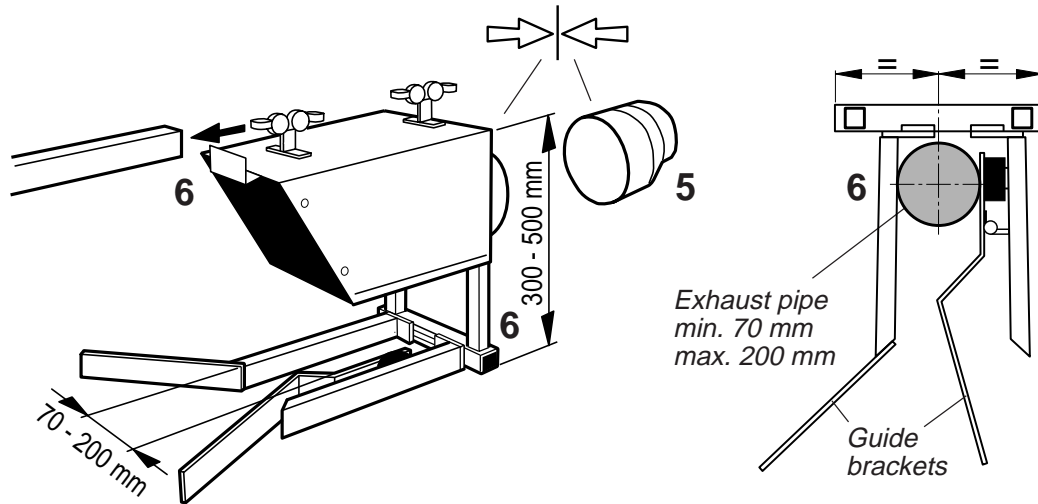

6. Insert the extraction unit into the track and adjust the position of the guide brackets sideways and vertically with the exhaust pipe positioned according to the figure. The guide brackets fit exhaust pipes with a diameter from minimum 70 mm to maximum 200 mm.

7. Suspend the hose up by threading the carriers into the guide track. **Make sure the carriers are installed in a straight line and that they do not foul in the track joints.**

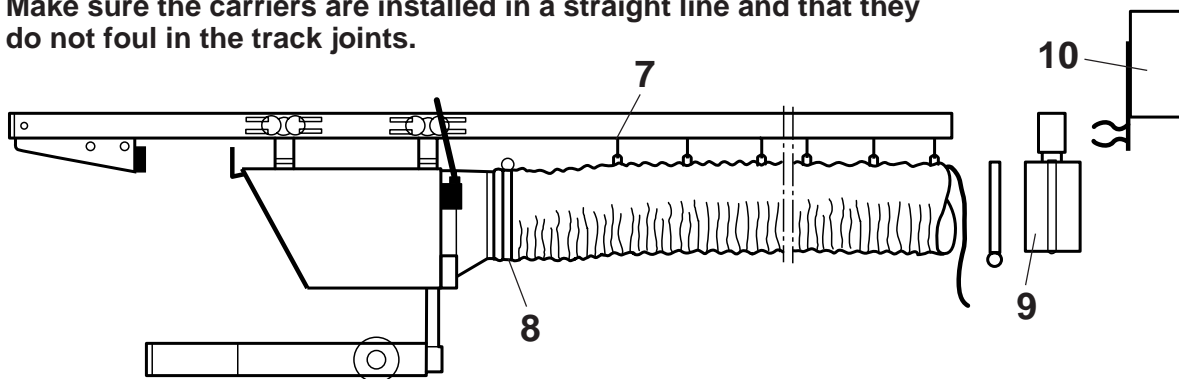

8. Connect the hose onto the extraction unit by using the hose clip. Connect the cable from the hose to the cable connectors from the connection box on the extraction unit.

9. Install the spigot into the bottom edge of the rail and attach the hose using the clip.

10. Install the rectifier on the bottom edge of the rail and connect the cable from the hose.

11. Install the disconnection plate to the front part of the track 0,5 m from the end of the track.

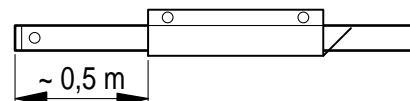

Wiring Diagram

Connection to the mains from the transformer should only be carried out by qualified electrician.

1. Transformer (not included in basic package) equipped with fuse (class 2, USA/Canada) secondary voltage: 24 V, capacity: minimum 20 VA
2. Rectifier.
3. Circuit breaker, activated by stop pin, mounted on the extraction hood.
4. Electro magnet, mounted on the guide bracket.

Connect the rectifier to secondary side of the transformer (24V). Then connect the single phase mains supply to the primary side of the transformer.

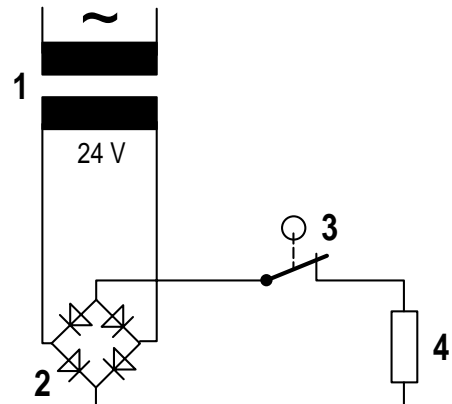

Fan Selection

Fans are not included in the basic package. For the best results, one fan per extraction unit is recommended, each connected so that it is controlled by opening and closing the garage door. It is also possible to connect several units to a central fan.

The following Nederman fans are suitable for installation with the exhaust extraction system.

	Part No. 510122	Part No. 510222
Motor output:	0,75 kW	0,75 kW
Rotation speed:	2800 r/m	3400 r/m
Power supply:	110-120V / 200-240 V 1-phase, 50 Hz	115V / 230 V 1-phase, 60 Hz
	Part No. 510422	Part No. 510522
Motor output:	0,75 kW	0,75 kW
Rotation speed:	2800 r/m	3400 r/m
Power supply:	200-240 / 380-420 V 3-phase, 50 Hz	200-240 / 380-420 V 3-phase, 60 Hz

Installation Checklist

When the mechanical assembly, fan connection and electrical installation of the exhaust extraction unit is complete, the system is ready for use after double-checking the following points.

- Check that the guide brackets of the extraction unit do not catch any part of the vehicle.
- Check, after disconnection, that the extraction unit remains up to the safety stop and that the guide brackets are fully opened.
- Check, after disconnection, that the track returns to its neutral position in the guide tracks.
- Check that the garage door can open freely without interference with the track.

WARNING!

Damage to the product can result if the exhaust extraction system is not used and maintained in the proper manner.

The system must not be used when working on the vehicle's fuel system, when recharging the batteries or whenever there is a risk for inflammable dust or explosive gases.

Maintenance Instructions

The extraction system is designed and tested for hard duty and does not require any service under normal conditions. However, the following points should be checked regularly throughout the year.

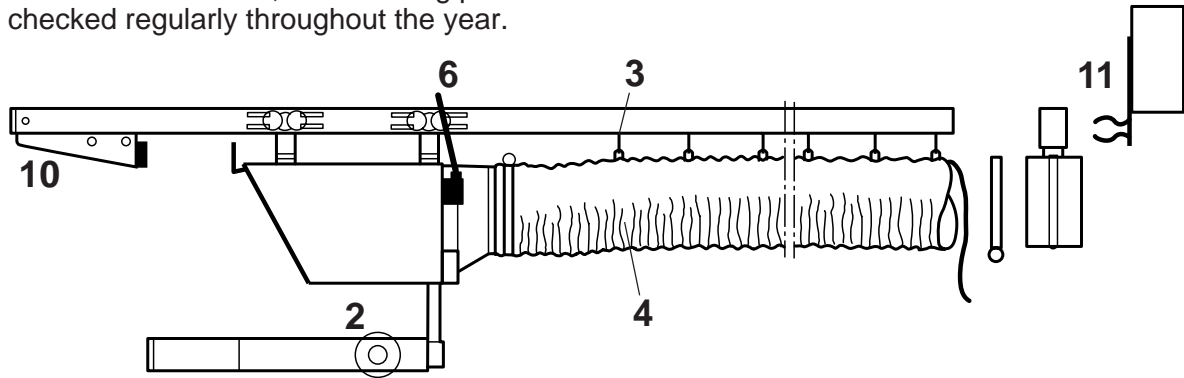

1. The guide track fixing bolts.
2. The electro magnetic operation in the extraction unit. Clean the magnet when necessary.
3. The hose's carriers.
4. The hose.
5. The extraction unit's guide wheel operation.
6. The circuit breaker positioned on the extraction unit. Check the break pin and operation.
7. The rubber flaps of extraction unit.
8. The position of extraction unit horizontally and vertically against the exhaust pipe.
9. The guide brackets.
10. The safety stop.
11. Electrical installation (see wiring diagram).

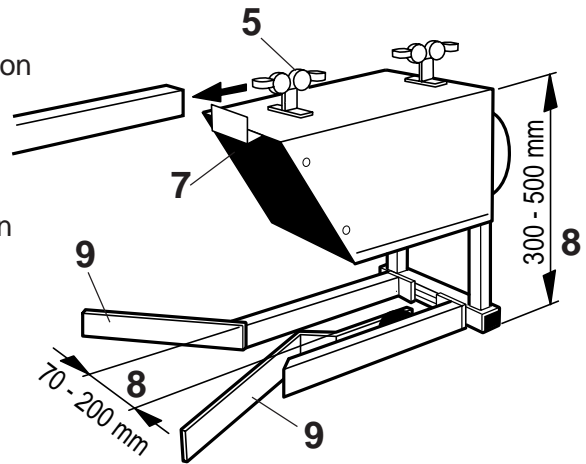

Spare Parts

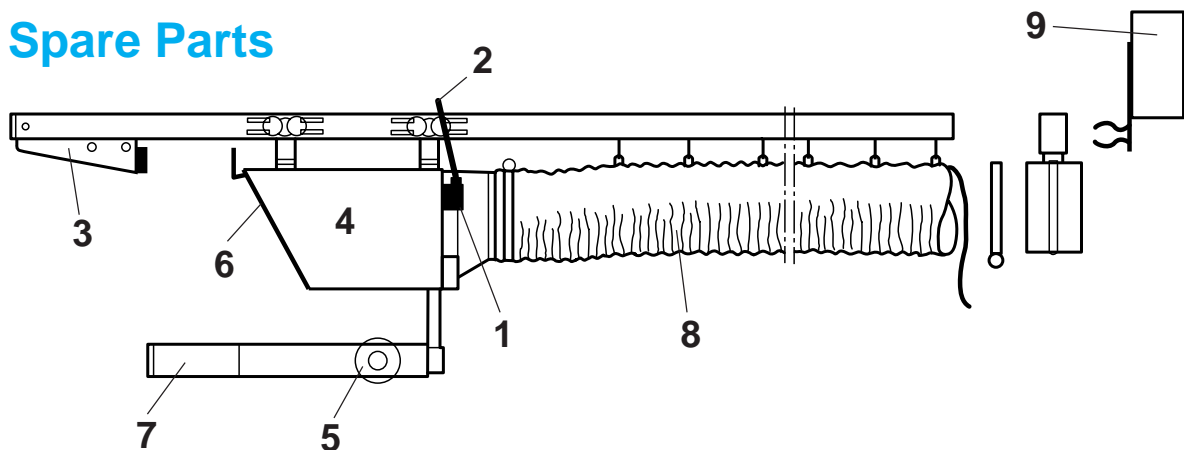

Ordering Instructions

When ordering spare parts always state:

- A. Part No. and Control No.
(see sign plate)
- B. The spare part's name and number
(see spare parts list).
- C. The track length.
- D. Quantity of parts required.

Spare Parts List

- | | |
|--------------------|-----------------------------|
| 1. Micro switch | 6. Rubber protection strip |
| 2. Break-pin | 7. Guide brackets, pair |
| 3. Safety stop | 8. Hose incl. carrier units |
| 4. Extraction hood | 9. Rectifier |
| 5. Magnet | |